

SUCTION CUPS / Bellows & Universal

VBU55



Features and Strengths

Widely cover for increased degree of height compensation
Excellent for curved products and separating thin sheet in stocks

Examples of use

Convex surface, Plastic bag, Metal sheets, Plywood,
Carton box, Cement sack



Recommended Lifting Force (Max.)

Model	Volume (cm ³)	Lifting Force (Kg) - Perpendicular		
		- 20 kPa	- 60 kPa	- 90 kPa
VBU55	28.00	7.50	9.80	12.05

※ The lifting force above does not include safety factor

Material Specifications

Material	Hardness Shore (°)	Color	Temperature (°C)
NBR	60	Black	-20~110
Silicone	55	Red	-70~200
White Silicone	55	Translucent White	-70~200
White Silicone (FDA)	55	Translucent White	-70~200
Polyurethane	60	Translucent Orange	0~60

※ For additional material, see page 32~33

Material Resistance

Description	NBR	Silicone	White Silicone	Polyurethane
Wear Resistance	Excellent	Good	Good	Excellent
Oil	Excellent	Poor	Poor	Excellent
Weather / Ozone	Fair	Excellent	Excellent	Excellent
Alcohol	Good	Good	Good	Fair
Acid	Fair	Poor	Poor	Fair

Dimension

[Unit : mm]

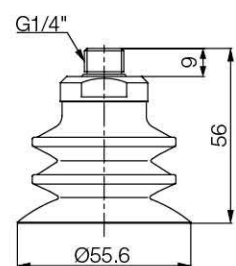

[With 14M fitting]

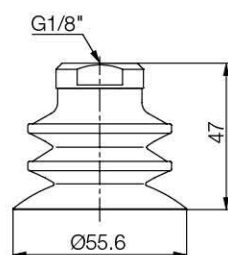

[With 18F fitting]

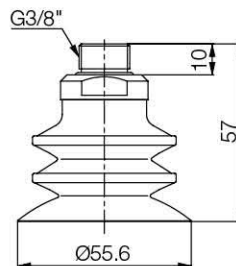

[With 38M fitting]

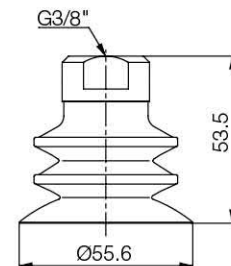

[With 38F fitting]

I Build an Ordering No.

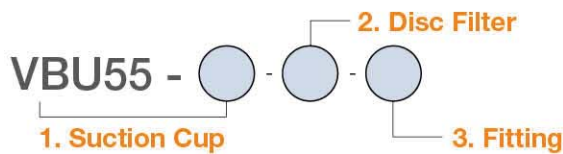

1. Suction cup	Description	Symbol
	Double bellows – universal suction cup, 55mm diameter, Nitrile (NBR)	VBU55-N
	Double bellows – universal suction cup, 55mm diameter, Silicone	VBU55-S
	Double bellows – universal suction cup, 55mm diameter, White silicone	VBU55-WS
	Double bellows – universal suction cup, 55mm diameter, White silicone (FDA)	VBU55-WS (FDA)
	Double bellows – universal suction cup, 55mm diameter, Polyurethane	VBU55-PU
2. Disc filter	Description	Symbol
	No disc filter	Blank
	Disc filter, Polyethylene	F
3. Fitting	Description	Symbol
	Fitting, G1/8 female	18F
	Fitting, G1/8 female, Mesh filter	M-18F
	Efficiency valve, Fitting, G1/8 female	18F-EV
	Fitting, G1/8 female, Old profile	18FO
	Fitting, G1/8 female, Old profile, Mesh filter	M-18FO
	Efficiency valve, Fitting, G1/8 female, Old profile	18FO-EV
	Fitting, G1/4 male	14M
	Fitting, G1/4 male, Mesh filter	M-14M
	Efficiency valve, Fitting, G1/4 male	14M-EV
	Fitting, G3/8 male	38M
	Fitting, G3/8 male, Mesh filter	M-38M
	Efficiency valve, Fitting, G3/8 male	38M-EV
	Fitting, G1/8 female, For silicone material	18FB2
	Fitting, G1/8 female, Mesh filter, For silicone material	M-18FB2
	Efficiency valve, Fitting, G1/8 female, For silicone material	18FB2-EV
	Fitting, G1/4 male, For silicone material	14MB2
	Fitting, G1/4 male, Mesh filter, For silicone material	M-14MB2
	Efficiency valve, Fitting, G1/4 male, For silicone material	14MB2-EV
	Fitting, G3/8 male, For silicone material	38MB2
	Fitting, G3/8 male, Mesh filter, For silicone material	M-38MB2
	Efficiency valve, Fitting, G3/8 male, For silicone material	38MB2-EV

SUCTION CUPS / Bellows & Universal

I Spare Parts – Rubber Parts

Part No.	Description	Weight (g)	Color
VBU55-N	Double bellows – universal suction cup, 55mm diameter, Nitrile (NBR)	17.83	Black
VBU55-S	Double bellows – universal suction cup, 55mm diameter, Silicone	15.25	Red
VBU55-WS	Double bellows – universal suction cup, 55mm diameter, White silicone	15.32	Translucent White
VBU55-WS (FDA)	Double bellows – universal suction cup, 55mm diameter, White silicone (FDA)	15.32	Translucent White
VBU55-PU	Double bellows – universal suction cup, 55mm diameter, Polyurethane	19.14	Translucent Orange

[Unit : mm]

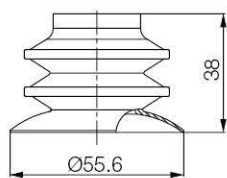

[Rubber part]

I Spare Parts – Disc Filter

Part No.	Description	Weight (g)
VTFE-BU55	Disc filter, Polyethylene	1.06

I Spare Parts – Fittings

Part No. (Code No.)	Fitting size	Description	Weight (g)
350 000 3312	18F	G1/8 female	5.68
350 000 4312	18F-F	G1/8 female, Mesh filter	5.73
350 010 3312	18F-EV	Efficiency valve, G1/8 female	5.63
350 000 1312	18FO	G1/8 female, Old profile	10.12
350 000 4912	18FO-F	G1/8 female, Old profile, Mesh filter	10.2
350 010 1312	18FO-EV	Efficiency valve, G1/8 female, Old profile	10.37
350 000 3405	14M	G1/4 male	5.88
350 000 3805	14M-F	G1/4 male, Mesh filter	5.92
350 010 3405	14M-EV	Efficiency valve, G1/4 male	6.03
350 000 3505	38M	G3/8 male	9.16
350 000 3905	38M-F	G3/8 male, Mesh filter	9.56
350 010 3505	38M-EV	Efficiency valve, G3/8 male	9.46
350 000 3344	18FB2	G1/8 female, For silicone material	15.33
350 000 4344	18FB2-F	G1/8 female, Mesh filter, For silicone material	15.81
350 010 3344	18FB2-EV	Efficiency valve, G1/8 female, For silicone material	15.95
350 000 3443	14MB2	G1/4 male, For silicone material	16.69
350 000 3843	14MB2-F	G1/4 male, Mesh filter, For silicone material	17.22
350 010 3443	14MB2-EV	Efficiency valve, G1/4 male, For silicone material	17.26
350 000 3543	38MB2	G3/8 male, For silicone material	16.77
350 000 3943	38MB2-F	G3/8 male, Mesh filter, For silicone material	17.28
350 010 3543	38MB2-EV	Efficiency valve, G3/8 male, For silicone material	17.06

